

Lidgerwood Grocery Store Project

A Community Funded NEW Grocery Store!

A Full Service Grocery



Lidgerwood Progressive Development Corporation

PO BOX 117

Lidgerwood, ND 58053

A 501C-3 Non-profit

Lidgerwood Grocery Store Project

A Full Service Grocery

Through private and corporate donations, the Lidgerwood Progressive Development Corporation (a 501c-3 non-profit) will raise the funds to build a new grocery store on the site of the former Lidgerwood Market. The need is great and community support is required to meet this goal. The financial requirements are detailed below.

Land	\$ 25,000
Building	275,000
Finish Interior	100,000
Electrical	110,000
Plumbing	85,000
Equipment	542,000
Point of sale	45,000
Contingency	218,000
Total	\$1,400,000



Why Non-Profit?

The margins in the grocery business are very small. The loss of grocery stores in rural areas is at epidemic proportions. The only way to attract and retain an operator is for progressive communities to fund the physical site (building and equipment) and then lease to an operator. A non-profit can also apply for grants and zero percent financing. All donations are tax deductible.

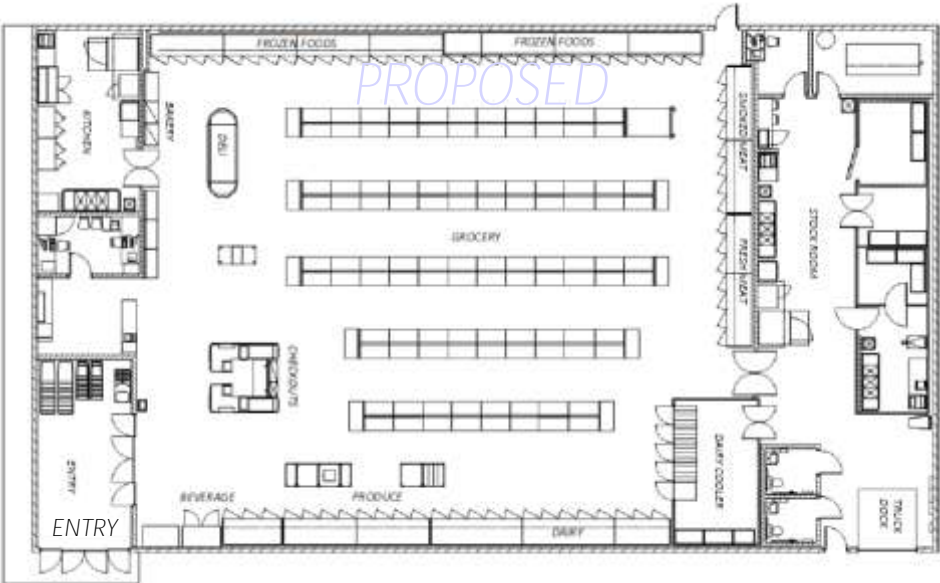

72'x120'

Lidgerwood Grocery Store Project

What happens to communities that lose their grocery?

“Since 2014, 30 full service grocery stores have closed or are no longer full service in 137 ND towns with fewer than 2100 people.”

-Lori Capouch, Rural Development Director, ND Rural Electric & Telecommunications Development Center

Property values decline, other businesses lose traffic and sales. Towns wither and die. The homebound and elderly often must leave to live near a grocery. A grocery is the anchor to every viable town and city.



Other reading:

Saving the Small Town Grocery Store

<https://www.cfra.org/renewrural/grocery>

The future of rural grocery stores (U of M)

<https://extension.umn.edu/vital-connections/future-rural-grocery-stores>

Video : <https://www.youtube.com/watch?v=cNzICXITNps&t=15s>



Demographics

Lidgerwood is at the junction of two state highways 40 miles from Wahpeton

The Lidgerwood Grocery will serve an area from Gwinner to Hankinson and Wyndmere to Veblen SD.

7000 people, 3000 households in a 20 mile radius



Lidgerwood Grocery Store Project

Our community has so much to offer except the main anchor to any community – a grocery store. There are times when small communities have to step up in order to get things done, this is one of those times! Each generation has faced challenges and many of their accomplishments are among those offerings listed below. We can make this happen but we need everyone to contribute to this project not only to fulfill the present needs, but for future generations who want to make this area their home. Let's join together and continue to grow our community and add to this impressive list of offerings!

<i>Agronomy Center</i>	<i>Ambulance/EMT</i>	<i>American Legion</i>	<i>Auto Parts Store</i>	<i>Banks</i>
<i>Barber</i>	<i>Bars</i>	<i>Baseball Diamond</i>	<i>Binding and Laminating</i>	<i>Body Shop</i>
<i>Bowling Alley</i>	<i>C-Stores</i>	<i>Camp Grounds</i>	<i>Car Dealer</i>	<i>Child Care</i>
<i>Chiropractor</i>	<i>Churches</i>	<i>City Office</i>	<i>Clinic</i>	<i>Community Center</i>
<i>Construction</i>	<i>Dentist</i>	<i>Dining</i>	<i>Elementary & High School</i>	<i>Elevator</i>
<i>Fire Department</i>	<i>Fitness Center</i>	<i>Floral Shop</i>	<i>Funeral Home</i>	<i>Golf Course</i>
<i>Hair Salons</i>	<i>Hardware</i>	<i>Implement Dealers</i>	<i>Knights of Columbus</i>	<i>Library</i>
<i>Lumber Yard</i>	<i>Massage Therapists</i>	<i>Mechanics</i>	<i>Motel</i>	<i>Museum</i>
<i>Nail Salon</i>	<i>ND State HWY Dept</i>	<i>Outdoor Amphitheater</i>	<i>Parks</i>	<i>Pharmacy</i>
<i>Post Office</i>	<i>Quilt Shop</i>	<i>Retirement Center</i>	<i>Seed Dealers</i>	<i>Senior Center</i>
<i>Softball Diamond</i>	<i>Social Clubs</i>	<i>Swimming Pool</i>	<i>Water Conditioning</i>	<i>Welding & Machine Shop</i>
<i>Well Drillers</i>				

“Alone we can do so little – together we can do so much!”

The Lidgerwood Progressive Development Corporation is the backbone of this fund raising campaign. It is a Community Development Corporation (CDC) with a mission to promote economic development that serves the citizens and sustains the city of Lidgerwood ND and surrounding communities.

- Board members:*
- Weldon Hoesel, President (701) 640-4041*
 - Brian Baldwin, Vice President (701) 640-1966*
 - Ron Heley, Secretary-Treasurer (701) 640-0026*
 - Dave Breker, Board Member (701) 538-4343*
 - Darby Harles, Board Member (701) 640-3303*

**Your Support
is Greatly
Appreciated!**